

Land late of
Samuel Hess decd.
now Henry Hess.

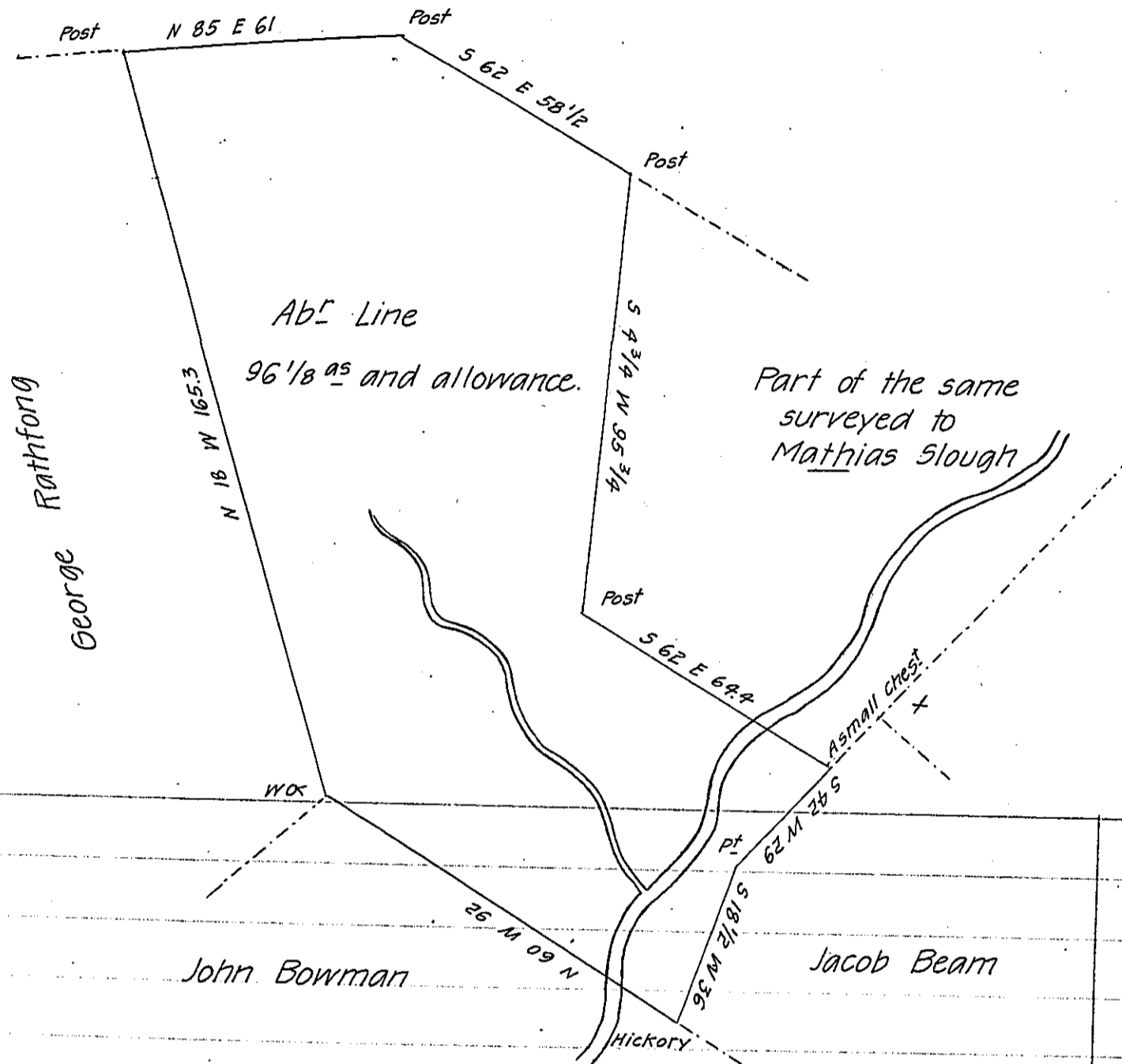

A draught of a piece or Tract of Land situate in Carrestogoe
Township Lancaster County containing $96\frac{1}{8}$ ac and the allowance
of six pr. ct. for roads &c. Surveyed the 21st day of August A. D.
1792 for Abraham Line (in right of the heirs of Samuel Meyer decd.)
It being part of a larger tract of $144\frac{7}{8}$ ac and allowance surveyed
unto the said Samuel Meyer decd. by virtue of a warrant dated
the 15th day of March A. D. 1749.

To Daniel Brodhead Esq. P^r Henry Ream D. S^r
Surveyor General.

IN TESTIMONY that the above is a copy of the original remaining on file in
the Department of Internal Affairs of Pennsylvania, made
conformably to an Act of Assembly approved the 16th day of
February, 1833, I have hereunto set my Hand and caused
the Seal of said Department to be affixed at Harrisburg,
this fifteenth day of May 1906.

Isaac B. Rowen
Secretary of Internal Affairs.